

A large industrial packaging machine, likely a Vervo V300, is shown in a clean, white environment. The machine features a complex system of rollers, guides, and a central control panel with a touchscreen display and several buttons. The Vervo logo is visible on the side of the machine. The image is overlaid with a blue and orange geometric design consisting of rounded rectangles and lines.

we
pack
'em all

VERVO

About Vervo

Founded in 1996 with the scope of manufacturing differentiated machinery by developing innovative projects and providing automation services for the companies operating in industrial area, VERVO Advanced Packaging Technologies has been providing services in secondary packaging and end of line automation systems since 2010. VERVO follows the latest trends in the world and provides the most suitable and innovative solutions for the unique secondary packaging process needs of the companies for already packaged products.

As VERVO Advanced Packaging Technologies, we work with leading companies of the industry including food services, chemistry, cosmetics, personal care products and fast-moving consumer goods which are intense in terms of secondary packaging applications such as boxing/case packing. For improving productive activities of the company, increasing production rates and profitability to higher levels, we offer Case/Box Erectors, Robotic Case Loading Systems, Case Closers, Compact Case Packing/Boxing Machinery for different case types "Wraparound, Tray, Tray&Lid, Robotic Palletizing Systems and Conveyor Solutions" with our qualified teams in design to software in our 5,000 m2 indoor facility located in GEPOSB.

Our Mission

With the awareness that high technology and efficiency improving systems are requirements, providing customer needs and satisfaction oriented, productivity increasing, sustainable and hassle-free advanced packaging and palletizing systems by bringing finest quality equipment together with our creative ideas.

Our Vision

As a domestic machine manufacturer, being one of the leading end of line automation companies of the world with the goal of always being the best.

Our Policies

- Honesty and Confidence

We believe that long term partnerships are based on mutual trust. Consequently, our priority is to handle every matter with honesty and clarity.

- Innovation and Continuous Development

While technological developments are so fast in machinery industry, we continuously change ourselves and develop by following recent changes in order to address customer needs and pursue our goals in a competitive approach.

- Respect to Time

We acknowledge the importance of producing good and quality machinery and sustainable systems in a timely manner. Therefore, we determine the timing of the projects together with our customers and pay utmost attention being faithful to the schedule.

- Privacy

Information provided by our customers are kept confidential unless otherwise indicated. If customers exclusively require confidentiality for the finished product or system, we punctiliously adhere to the requirements of our customers.

CASE PACKING

CASE ERECTOR SYSTEMS

Systems that prepare the cases that you want to put your products in. For loading process, they prepare the appropriate case according to your choice such as Tray, A-Box, Display, etc.

A1- A-Box Case Erector

A2- Tray Erector

A3- Box Erector



CASE LOADING SYSTEMS

Do you have an already packed case and want to automatically load the products? By analyzing end of line, we fulfill the loading process with system scenarios such as robotic "Pick&Place" and "Free Fall".

CASE SEALER SYSTEMS

A4- A-Box Case Closer

A5- Random A-Box Case Closer

A6- Lid Closer

Systems that carry out the upper/lower closing of the cases loaded with your products. Upper/lower parts of A-Box type cases and covers of Tray type cases are closed using hot melt glue.



COMPACT END OF LINE CASE PACKING

A-BOX SIDE LOADING

ACP 320 S



Systems offering total solution for A-Box (American Type) Case Erector, Product Loading and Case Closing processes. According to you needs, we offer our 2 different models with top or side loading options based on product type.

WRAPAROUND CASE PACKING MACHINERY

**WSR 500
WSR 500 DUO**



We offer loading options to match your preferences regarding the appearance of the products on shelves. Systems that offer case packing/boxing solutions for vertical or horizontal laying, boxes ready for store shelves, Wraparound, Tray&Lid type boxing/case packing with "Shelf Ready – Store Ready" concept. DUO models with dual product entry offer unique solutions for mixed cases/boxes.

A-BOX TOP LOADING

ACP 320 T



TRAY & LID CASE PACKING MACHINERY

**TLC 300
TLC 300 DUO**



ROBOTIC PICK AND PLACE

In these modular systems including Case preparation, Product placement and Case Closing processes, we use industrial robots like Delta and Scara which are suitable for "Pick&Place" concept in terms of speed. Each process can be increased according to product capacity and your requirements and they are ideal solutions especially for display box type.

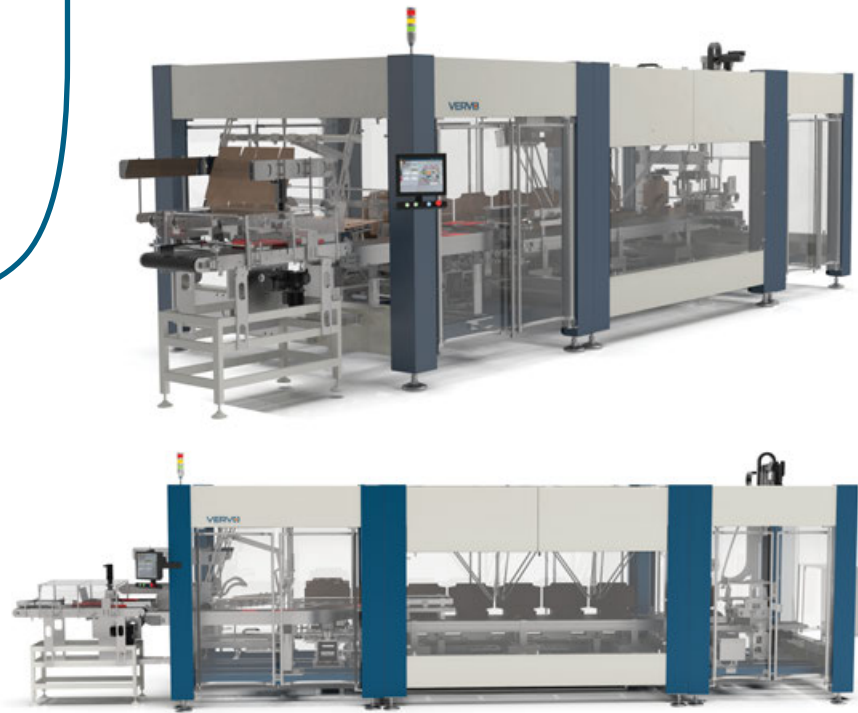

PALLETIZING SYSTEMS

From line to shipping, we cover the whole process for your cases. We deliver turnkey projects with automatic pallet feeding, robotic palletizing, loaded pallet transfer and AGV shipping systems within the scope of robotic palletizing systems.

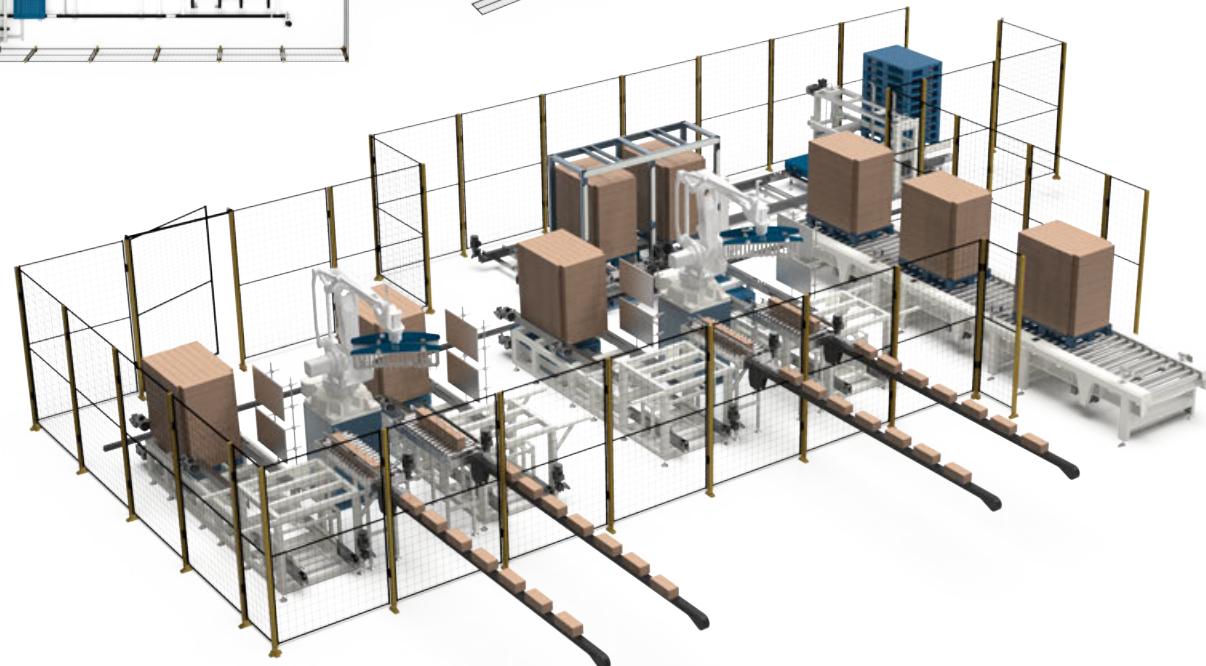
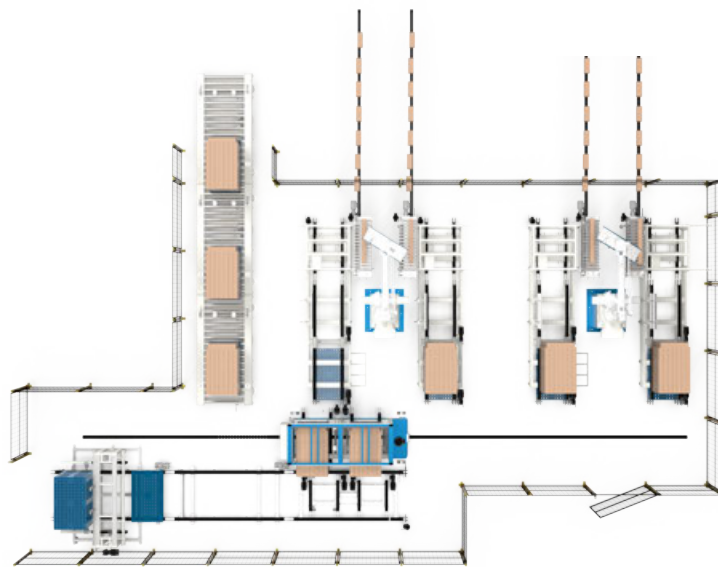

CONVEYOR SYSTEMS

All transportation processes of products, cases and pallets coming from packaging lines to shipping or storage yards carried out with modular plastic chain, belt and roller conveyors.



CS 1- Modular Conveyor Systems

CS 2- Roller Conveyor System

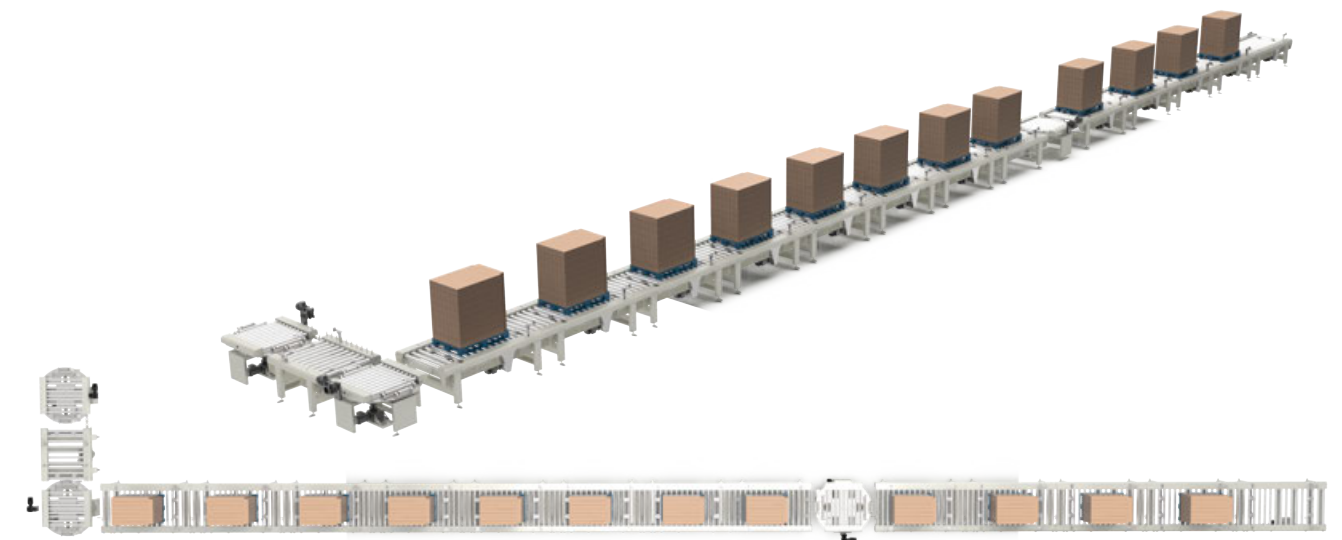

SMART CONVEYING SYSTEMS

We provide solutions performing line integration, line separation and distribution systems required for case packing machinery and palletizing systems with "Smart in Feed" concept and smart conveyors.

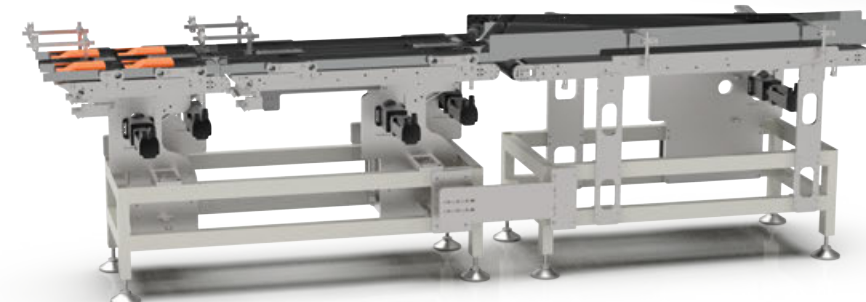
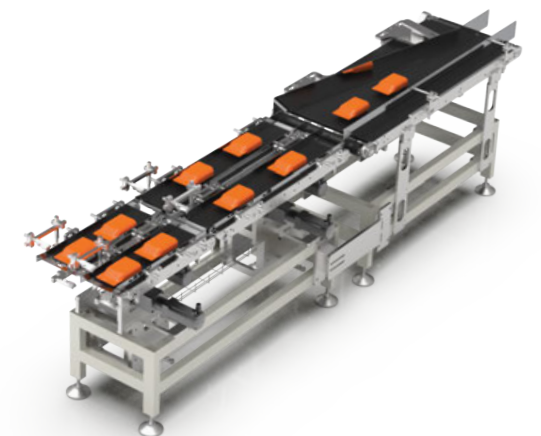

SERVICE & AFTER SALE



As **VERVO**, we are aware that gaining customer is hard and maintaining its continuity is even harder. Therefore, we organize our **“Service and After Sale”** services.

With our qualified service technicians and engineers, our primary goal is maintaining top level service and quality and meeting your requirements and needs in the shortest time right after the installation. Because we know that even in the most trouble-free businesses and under the best maintenance conditions unexpected failures may happen. At this point, our field teams which comprise of engineers and technicians are at your service to respond your demands and provide solutions.

Our machines have remote access feature as a standard and after getting failure codes online we can remotely access and provide solutions within minutes. For mechanical failures, we provide on-site service support in the shortest time possible. Annual preventive maintenance and care agreements ensure our machinery to work safely for years even after warranty period expires.

we
pack
'em all

VERVO

gelişmiş paketleme teknolojileri
advanced packaging technologies

www.vervo.com.tr
www.vervopackaging.com
info@vervo.com.tr

İnönü Mah. Gebze Plastikçiler OSB 4. Cadde 42. Sok.
No.4 Gebze/KOCAELİ 41400 TURKEY
+90 262 658 07 95